

THOMAS AND ANDREA JACOBSON  
TOLL BROTHERS LOT 96 PAWC  
2228 LORELAI LN  
CARY, NC



Security Force Inc.

3631 Bastion Lane  
Raleigh, NC 27604

09/16/2020



MASTER- AUDIO PRE WIRE ONLY,  
ORIGIN ACOUSTIC BRACKETS AND  
GRILLS, BLANK PLATED VOLUME  
CONTROL LOCATION, HEAD END IN  
FAMILY RM.

LOT 96 PAWC  
2ND FLOOR  
TOLL/ JACOBSON

CAT6

MASTER- CD AND POWER @  
60", ARM TV MOUNT  
INSTALLED AFTER CLOSING

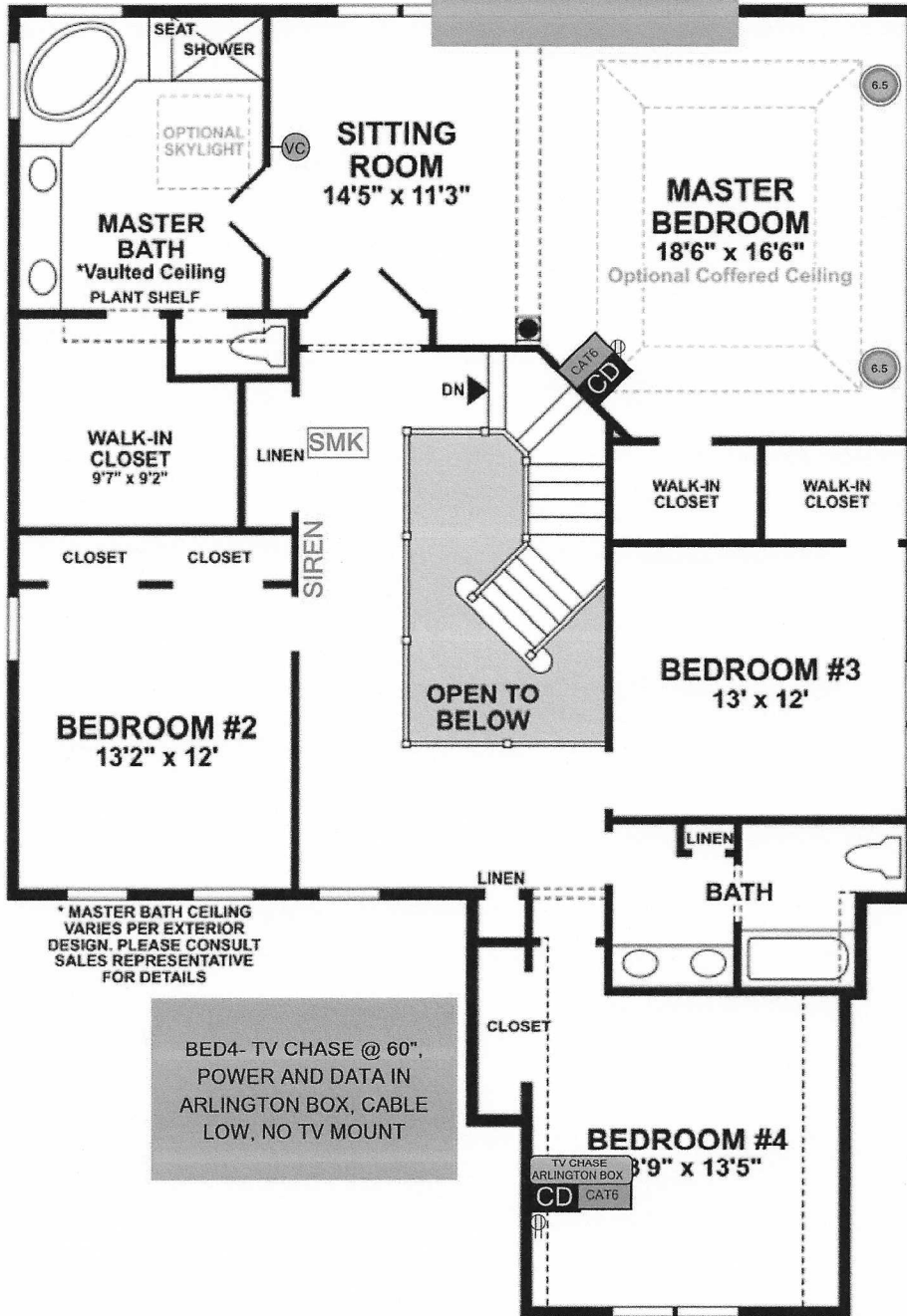

BED4- TV CHASE @ 60",  
POWER AND DATA IN  
ARLINGTON BOX, CABLE  
LOW, NO TV MOUNT

*Andrea Jacobson*

9/16/2020

9/16/2020

SIGNATURE

DATE



LOT 96 PAWC  
1ST FLOOR  
TOLL/ JACOBSON

FAMILY- TV CHASE @ 60", 1  
HDMI AND PULL STRING, NO  
TV MOUNT

KITCHEN- HOME AUDIO  
PRE-WIRE ONLY, ORIGIN  
ACOUSTIC BRACKETS AND  
GRILLS, BLANKED VOLUME  
CONTROL LOCATION,  
HEAD END IN FAMILY RM.

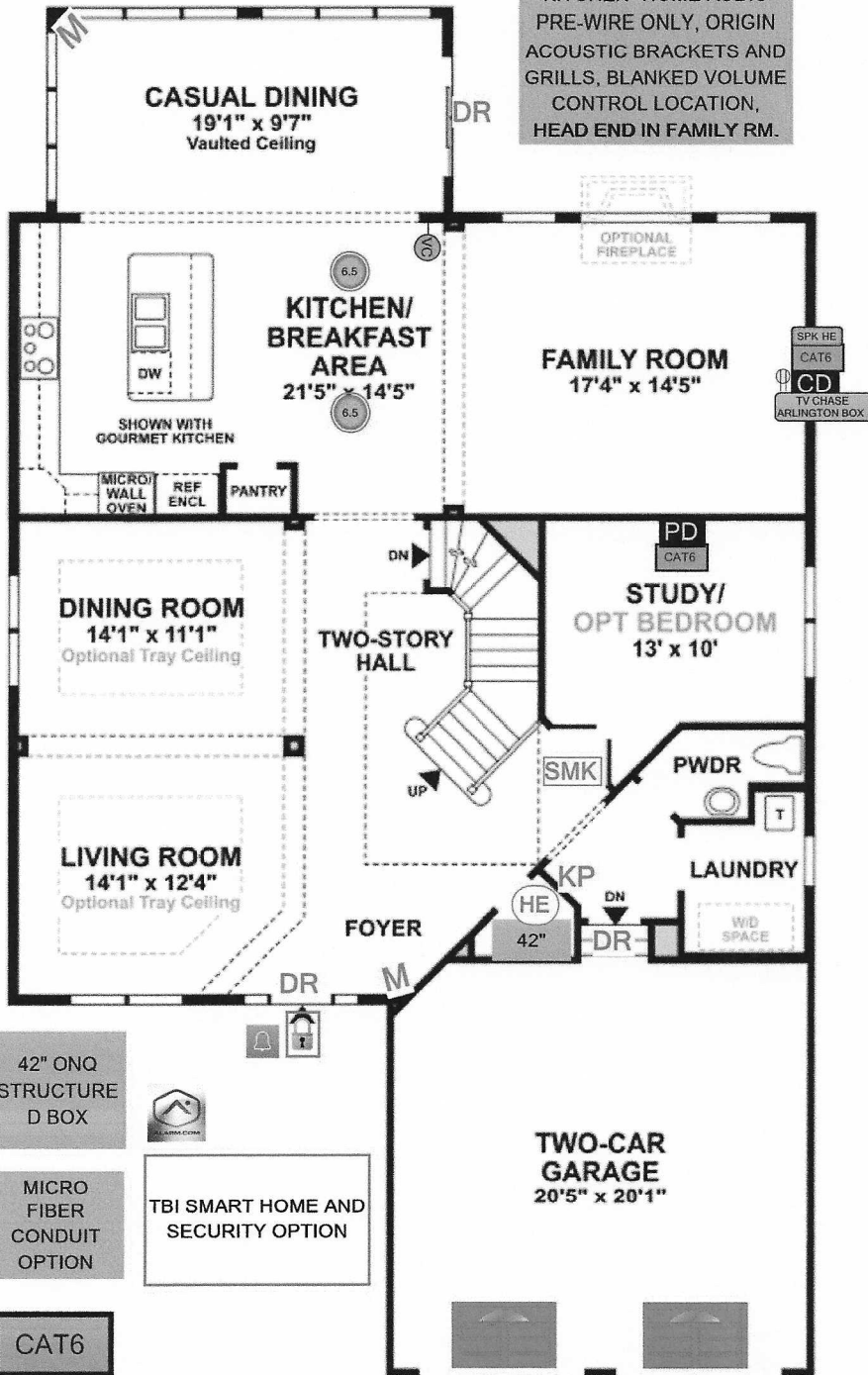

42" ONQ  
STRUCTURE  
D BOX



MICRO  
FIBER  
CONDUIT  
OPTION

TBI SMART HOME AND  
SECURITY OPTION

CAT6

*Handwritten signature*  
Andrea Jacobson

9/16/2020

9/16/2020

SIGNATURE

DATE





CLIENT INFORMATION

THOMAS AND ANDREA JACOBSON  
 TOLL BROTHERS LOT 96 PAWC  
 Mobile: 3107530760 AND 0761  
 TTJAC0B1@YAHOO AND1E84@YAHOO  
 2228 LORELAI LN  
 CARY, NC



COMPANY INFORMATION

Security Force Inc.  
[Securityforceinc.com](http://Securityforceinc.com)  
 3631 Bastion Lane  
 Raleigh, NC 27604  
 BLAKE HENDRICKSON  
[Bhendrickson@securityforceinc.com](mailto:Bhendrickson@securityforceinc.com)  
 Mobile :984-269-3859

NAME/INFO	DESCRIPTION	UNIT PRICE	QTY	PRICE
<b>GLOBAL</b>	<b>BASE HOME PACKAGE</b>			
 <p><b>Structured Wiring Panel</b>                      Most commonly used for homes, most reliable way to organize your data network in your home.</p>	 <p><b>Toll Brothers Included Structured Wiring Package</b>                      42" Structured Wiring Can                      6 Single Media Drops/ 3 CABLE, 3 ETHERNET.                      CAT6 Wiring</p>	\$0.00	1	\$0.00
<b>Toll Brothers Included Package - NEW 440</b>	<p><b>Comment :</b> TOLL BROTHERS INCLUDED MEDIA LOCATIONS (3) CABLE-- FAMILY, MASTER, BED 4. (3) CAT6 ETHERNET-- FAMILY, MASTER, STUDY. 42"e; ONQ STRUCTURED WIRING BOX.</p>			
	<b>SMART HOME SOLUTIONS/ SECURITY</b>			
<b>SECURITY AND SMART HOME INTEGRATION</b>	<p>SECURITY AND SMART HOME INTEGRATION/ SMART LOCK, GARAGE DOOR CONTROL SET UP AND HVAC INTEGRATION.                      ONE TIME SET UP FEE , DEMO INCLUDED</p>	\$250.00	1	\$250.00
	<b>Comment :</b> INTEGRATION SET UP FEE			
<b>078153 - Skybell WiFi Doorbell Camera</b>	<p><u>Wi-Fi Doorbell Camera with Two-Way Audio and Night Vision</u>  <b>Comment :</b> VIDEO DOORBELL UNIT/ WIFI REQUIRED</p>	\$445.00	1	\$445.00
<b>FIRST FLOOR</b>	<b>SMART HOME SOLUTIONS/ SECURITY</b>			
 <p><b>Motion Detector</b>                      Cost effective sensor provides 120' x 120' range.                      -Cable of emergency alarm.                      40-100' - 100 degrees of downward viewing of motion.</p>	 <p><b>Motion Sensors</b> react to movement within your home or office when the systems is secured in away mode and not active if you decide to arm and stay in. Sensors can be pet friendly, set to cover large areas or even outdoors.</p>	\$130.00	1	\$130.00
<b>Motion Sensor</b>				
 <p><b>Smoke Detectors</b>                      Protect your loved ones, friends, pets, and property. Smoke detectors provide peace of mind and lower rates on your homeowners insurance. Save lives, your home and money. More than enough reasons to invest in a fire and life safety system.</p>	 <p><b>Monitored fire protection</b> provides peace of mind and lower rates on your homeowners insurance. Save lives , your home and money . More than enough reasons to invest in a fire and life safety system.</p>	\$145.00	1	\$145.00
<b>Smoke Detectors</b>				
<b>SECOND FLOOR</b>	<b>SMART HOME SOLUTIONS/ SECURITY</b>			
 <p><b>Smoke Detectors</b>                      Protect your loved ones, friends, pets, and property. Smoke detectors provide peace of mind and lower rates on your homeowners insurance. Save lives, your home and money. More than enough reasons to invest in a fire and life safety system.</p>	 <p><b>Monitored fire protection</b> provides peace of mind and lower rates on your homeowners insurance. Save lives , your home and money . More than enough reasons to invest in a fire and life safety system.</p>	\$145.00	1	\$145.00
<b>Smoke Detectors</b>				
<b>BASEMENT</b>	<b>SMART HOME SOLUTIONS/ SECURITY</b>			



Motion Sensors react to movement within your home or office when the systems is secured in away mode and not active if you decide to arm and stay in. Sensors can be pet friendly, set to cover large areas or even outdoors.

\$130.00 1 \$130.00

**Motion Sensor**

**KITCHEN DISTRIBUTED AUDIO**

**078146 - Audio Prewire - No Speakers**

EACH  
 Prewire Only for a Single Room of Distributed Audio  
 ORIGIN ACOUSTIC BZ68 Brackets and grills  
 (1)16/4 and (1) CAT5e from the HE to a VC location blanked.  
 (1) 16/2 to each speaker location blanked [depending on application].  
 Head End Location Blanked.  
**NO SPEAKERS OR AMPLIFIER INCLUDED IN THIS OPTION**  
 Comment : PRE-WIRE ONLY

\$255.00 1 \$255.00

**FAMILY BASE HOME PACKAGE**



110v 15amp Outlet to provide power for other systems

This option is not available for the Kitchen, any Bath, Garage or exterior area that requires a ground fault outlet.

\$95.00 1 \$95.00

**078143 - 110V 15amp Outlet**

Comment : POWER @ 60"e;

**HOME THEATER**

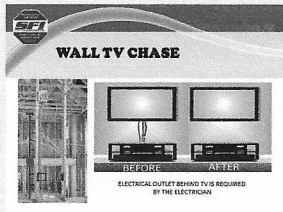

WALL TV CHASE with HDMI  
 (1) Arlington box at 60" (75" if over fireplace)  
 (1) 1.5" Conduit connecting Arlington Box to Media Outlet below with pull string. (MEDIA OUTLET SOLD SEPARATELY)  
 (1) 25' HDMI Cable Included for over fireplace.  
 OR  
 (1) 15' HDMI Cable Included for Up/Down Wall installation

\$255.00 1 \$255.00

**WALL TV CHASE**

**\*\*ELECTRICIAN TO ADD OUTLET \*\*\***  
**\*\*WALL MOUNT NO INCLUDED**  
 Comment : TV CHASE @ 60"e,, 1 HDMI ND PULL STRING, NO TV MOUNT

**STUDY STRUCTURED WIRING**

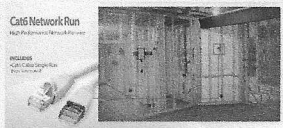

Achieve up to 10GB speeds with this upgraded Ethernet Cabling

1 Cat6 wiring from Central Wiring Enclosure  
 Wallplate  
 Termination on both ends

\$135.00 1 \$135.00

**Cat6 Data Outlet**

**\*\*DATA JACK NOT CONNECTED UNLESS SWITCH IS PURCHASED SEPARATELY. You will need to make that connection after close.**  
 Comment : PHONE CONNECTION

**MASTER BEDROOM BASE HOME PACKAGE**



110v 15amp Outlet to provide power for other systems

This option is not available for the Kitchen, any Bath, Garage or exterior area that requires a ground fault outlet.

\$95.00 1 \$95.00

**078143 - 110V 15amp Outlet**

Comment : POWER @ 60"e;

**DISTRIBUTED AUDIO**

**078146 - Audio Prewire - No**

EACH  
 Prewire Only for a Single Room of Distributed Audio  
 ORIGIN ACOUSTIC BZ68 Brackets and grills  
 (1)16/4 and (1) CAT5e from the HE to a VC location blanked.

\$255.00 1 \$255.00

**Speakers**

(1) 16/2 to each speaker location blanked [depending on application].

Head End Location Blanked.

**NO SPEAKERS OR AMPLIFIER INCLUDED IN THIS OPTION**

**Comment : PRE-WIRE ONLY**

**HOME THEATER**



This Full Motion quality built articulating bracket fits most 37"-70" TV's up to 110lbs. Mounting arms made of strong steel with convenient built-in wire guide for easier wire management. Post-installation level adjustment allows the TV to adjust 3° clockwise and counterclockwise to ensure TV is perfectly level

\$435.00 1 \$435.00

**Large Arm Mount**

**BEDROOM 4**

**BASE HOME PACKAGE**



110v 15amp Outlet to provide power for other systems

This option is not available for the Kitchen, any Bath, Garage or exterior area that requires a ground fault outlet.

\$95.00 1 \$95.00

**Comment : POWER @ 60"e;**

**078143 - 110V 15amp Outlet**

**STRUCTURED WIRING**

Achieve up to 10GB speeds with this upgraded Ethernet Cabling

1 Cat6 wiring from Central Wiring Enclosure  
Wallplate  
Termination on both ends

\$135.00 1 \$135.00

**\*\*DATA JACK NOT CONNECTED UNLESS SWITCH IS PURCHASED SEPARATELY. You will need to make that connection after close.**

**Cat6 Data Outlet**

**HOME THEATER**

**WALL TV CHASE with HDMI**

- (1) Arlington box at 60" (75" if over fireplace)
- (1) 1.5" Conduit connecting Arlington Box to Media Outlet below with pull string. (MEDIA OUTLET SOLD SEPARATELY)
- (1) 25' HDMI Cable Included for over fireplace.
- OR
- (1) 15' HDMI Cable Included for Up/Down Wall installation

\$255.00 1 \$255.00

**\*\*ELECTRICIAN TO ADD OUTLET \*\*\***

**\*\*WALL MOUNT NO INCLUDED**

**Comment : TV CHASE @ 60"e;, 1 HDMI AND PULL STRING, NO TV MOUNT**

**WALL TV CHASE**

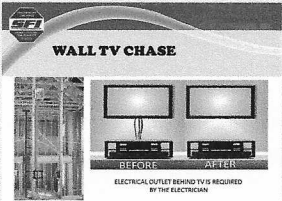

SUB TOTAL	\$3,255.00
<hr/>	
<b>TOTAL</b>	<b>\$3,255.00</b>

**Monitoring Charges**



*AD ZL*

**426  
ADVANCED  
INTERACTIVE**

BASIC INTERACTIVE THAT ADDS 24x7 SENSOR ACTIVITY. WHEN YOUR SYSTEM IS DISARMED, YOU CAN GET NOTIFICATIONS ON SENSOR ACTIVITY. (MEDICINE CABINETS, SAFES, LIQUER CABINETS, ETC...) PACKAGE EQUIPMENT INCLUDES 1 DSC Security Panel with Backup Battery 1 Keypad with Fire, Police, and Medical panic buttons at Garage Entry All Doors leading into the home, including the interior Garage Door. Does not include the Overhead Garage Door(s) 1 Interior Detection Device (Motion Sensor in Foyer OR Glass Break in Kitchen) Depending on Pets. 1 Interior Siren Wireless Communication to the Central Station for Monitoring General Note A Three (3) Year TBI Smart Home Solutions Monitoring Agreement must be completed at the time this option is selected.

\$39.99      1      \$39.99



*AD ZL*

**Pro Video  
Service**

Add on Service. Must purchase Option 426 before adding this option. View live video from up to 4 cameras simultaneously via your online account and mobile apps. Store up to 1,000 clips.

\$6.00      1      \$6.00

*Andrea Jacobson*

Client Signature

9/16/2020  
9/16/2020

Date Time

09/16/2020

Total Amount

\$3,255.00

Deposit Amount

LOCATION	SYSTEM	PACKAGE	DATE	COMMENT
Global	BASE HOME PACKAGE	Toll Brothers Included Package - NEW 440	2020-09-02 11:56:46	TOLL BROTHERS INCLUDED MEDIA LOCATIONS (3) CABLE-- FAMILY, MASTER, BED 4. (3) CAT6 ETHERNET-- FAMILY, MASTER, STUDY. 42"e; ONQ STRUCTURED WIRING BOX.
FAMILY	BASE HOME PACKAGE	078143 - 110V 15amp Outlet	2020-09-16 12:19:21	POWER @ 60"e;
Master Bedroom	BASE HOME PACKAGE	078143 - 110V 15amp Outlet	2020-09-02 11:58:45	POWER @ 60"e;
Bedroom 4	BASE HOME PACKAGE	078143 - 110V 15amp Outlet	2020-09-02 11:58:31	POWER @ 60"e;
Study	Structured Wiring	Cat6 Data Outlet	2020-09-02 11:55:51	PHONE CONNECTION
Global	Smart Home Solutions/ SECURITY	426 ADVANCED INTERACTIVE	2020-09-02 11:57:04	HARDWIRED ALARM OPTION WITH ALARM.COM APP CONTROL
Global	Smart Home Solutions/ SECURITY	Pro Video Service	2020-09-02 11:57:18	1000 MONTHLY VIDEO CLIPS
Global	Smart Home Solutions/	SECURITY AND SMART HOME	2020-09-02	INTEGRATION SET UP FEE

	SECURITY	INTEGRATION	11:57:50	
Global	Smart Home Solutions/ SECURITY	078153 - Skybell WiFi Doorbell Camera	2020-09-02 11:57:36	VIDEO DOORBELL UNIT/ WIFI REQUIRED
Kitchen	Distributed Audio	078146 - Audio Prewire - No Speakers	2020-09-16 12:46:42	PRE-WIRE ONLY
Master Bedroom	Distributed Audio	078146 - Audio Prewire - No Speakers	2020-09-16 12:46:28	PRE-WIRE ONLY
FAMILY	Home Theater	WALL TV CHASE	2020-09-16 12:47:04	TV CHASE @ 60"e;, 1 HDMI ND PULL STRING, NO TV MOUNT
Bedroom 4	Home Theater	WALL TV CHASE	2020-09-02 11:58:20	TV CHASE @ 60"e;, 1 HDMI AND PULL STRING, NO TV MOUNT